

Protecta FR Board 60mm in 100mm Concrete Wall Copper, Alupex Pipes Combustible (Elastomeric, Foam) or Non- combustible Insulation

Installation Instructions

1. Before installing Protecta® FR Board ensure that the surface of all service penetrations and surrounding construction is free from all loose contaminants, dust and grease.
2. The single layer of 60mm 2-S FR Board may be installed flush with either face or anywhere inbetween.
3. Cut the board to suit the aperture dimensions and type and size of service penetrations. All exposed and cut edges of the board can be sealed with Protecta® FR Acrylic prior to fitting which will act as an adhesive and ensure a smoke tight seal.
4. Board to be friction fitted and collars fitted both sides, then all joints, gaps or imperfections in the installed seal must be filled with Protecta® FR Acrylic on both sides.
5. Protecta® FR Board can be over-painted with most emulsion or alkyd (gloss) paints.
6. Apertures must be lined. Cavity insulation optional.

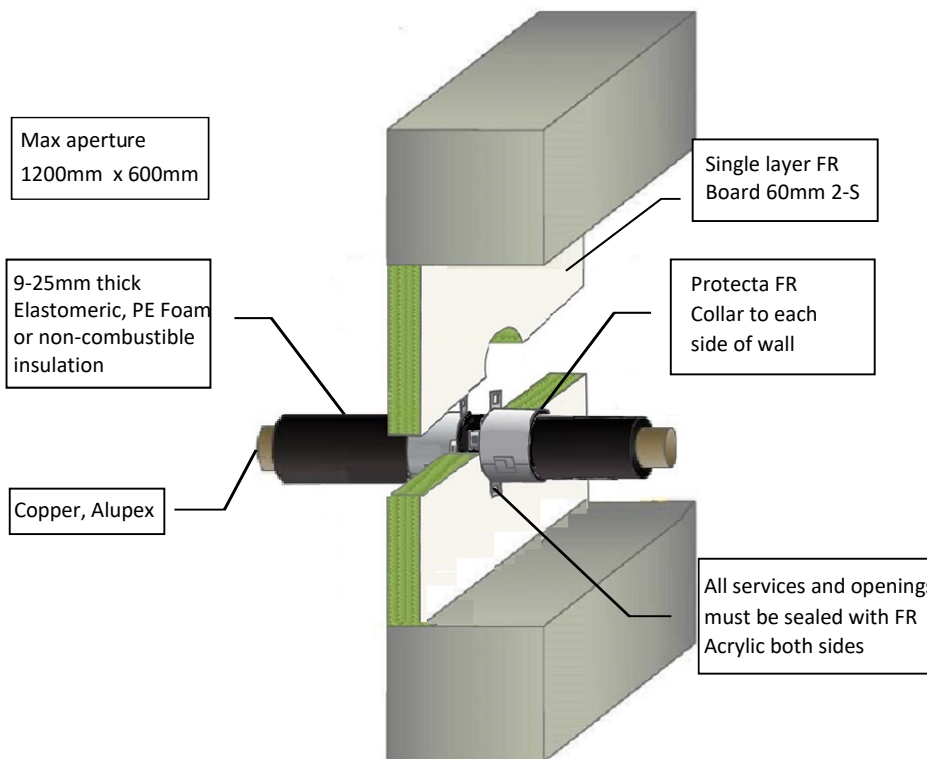

Minimum separations and limitations

An aperture can include several services, and they may also be different. Services within the system Protecta® FR Board seal do not require a minimum separation, except pipes where pipe insulation penetrates the seal and plastic pipe penetrations which should be a minimum of 30 mm from other services in the aperture. Services should be a minimum of 25mm from seal edges. The total amount of cross sections of services (including insulation) should not exceed 60% of the penetration area. The minimum permitted separation between adjacent apertures is 200mm.



As a part of our policy of on-going product development and testing, we reserve the right to modify, alter or change product specifications without giving notice. All information contained in this document is given in good faith and is provided for guidance only. Any drawings provided are for illustrative purposes only. As Polyseam has no control over the methods or competence of installation and of prevailing site conditions, no warranties, expressed or implied, is intended to be given as to the actual performance of the product mentioned or referred to herein and no liability whatsoever will be accepted for any loss, damage or injury arising from the use of the information given.

For all technical details on the products specified please refer to the technical data sheets that can be found on www.firestopcentre.co.nz

Signed and approved:

System/FPA Register ID# FC276

Products	Protecta FR Board Protecta FR Collar Protecta FR Acrylic
Application	Fire stopping of metal pipes with combustible or non-combustible insulation in concrete walls
Construction	Minimum wall thickness of 100mm and comprise concrete, aerated concrete or masonry, with a density of $\geq 650 \text{ kg/m}^3$.

Fire & Sound classification

Copper pipe up to 54mm diam with 50mm high Protecta FR Collar to each side - may be oversize to 110mm FRR -/60/30

Alupex pipe up to 75mm diam with 50mm high Protecta FR Collar to each side - may be oversize to 110mm FRR -/60/45

Alupex pipe up to 75mm diam with 60mm high Protecta FR Collar to each side - may be oversize to 125mm FRR -/60/60

Smoke-safe ($<0.1\text{m}^3/\text{h}$ smoke leakage at 200Pa)

Sound reduction (seal only) STC 55



Protecta®

Polyseam Ltd, 15 St Andrews Road, Huddersfield, West Yorkshire, HD1 6SB

Sheet size:	Drawn date & no:
A4	20/4/21

Scale:	Drawn by:
NTS	K.B